

156P60

PHOTOVOLTAIC MODULES

POLICRYSTALLINE FRAMELESS

eclipse
ITALIA

PROPERTIES

Photovoltaic module manufactured with 60 high efficiency polycrystalline cells for architectural integration.

WARRANTY

90% rated power output for 10 years

80% rated power output for 25 years

10 year product warranty

CERTIFICATES

Modules are certified according to: IEC 61215 ed.II

Modules are certified according to: IEC 61730

Conformity to the requirements: V CONTO ENERGIA DM 05/07/2012
ART. 5 COMMA 2 MADE IN EU

STRUCTURAL PROPERTIES

Size LxWxH	1655x990x5.5 mm
Weight	19 kg
Cells type	60 polycrystalline silicon cells with high efficiency
Cells dimensions	156x156mm
Ribbon	Bus bars of copper, tin and silver
Front Glass	Prismatic tempered glass high light transmittance, 4mm thickness, class U1
Encapsulation	EVA (Ethilene.vinyl acetate), UV stabilised
Backsheet (PYE)	PYE (Multilayer polyester-based)
Junction box	Ip 65 waterproof junction box fitted with 3 bypass diodes for effettive protection against "hot spots"
Connectors	2 cables long 1 mt section 4 mm with Tyco connector

CONDITION OF USE

Typical Application	24 V DC
Maximum Voltage	1000 V DC
Operating temperature	-40°C+85°C
Impact resistance to Hail	Ø 25 mm at 80 km/h
Wind	197 km/h max
Snow	551 kg/mq max
Application Class	A, safety class II

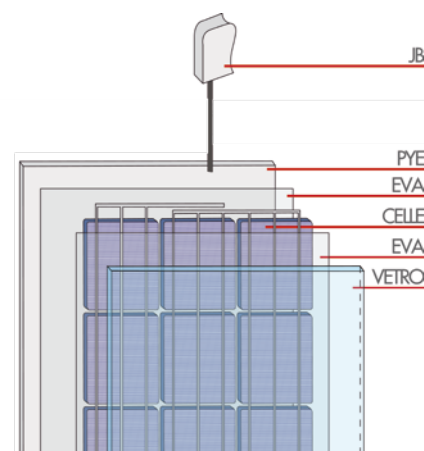

TÜV
INTERCERT
MADE IN EU

efficienza garantita
25 anni

156P60

PHOTOVOLTAIC MODULES

POLYCRYSTALLINE FRAMELESS

eclipse
ITALIA

ELECTRICAL CHARACTERISTICS*

Modules	SOL 220 PF	SOL 225 PF	SOL 230 PF	SOL 235 PF	SOL 240 PF	SOL 245 PF	SOL 250 PF
Module power (P Max)	220 Wp	225 Wp	230 Wp	235 Wp	240 Wp	245 Wp	250 Wp
Power tolerance	± 2,5 W	± 2,5 W	± 2,5 W	± 2,5 W	± 2,5 W	± 2,5 W	± 2,5 W
Maximum power voltage (Vpm)	29,26 V	29,39 V	29,51 V	29,68 V	29,76 V	29,89 V	30,03 V
Maximum power current (Ipm)	7,52 A	7,66 A	7,80 A	7,92 A	8,07 A	8,20 A	8,33 A
Open circuit current (Voc)	36,86 V	36,97 V	37,11 V	37,27 V	37,43 V	37,56 V	37,68 V
Short circuit current (Isc)	8,07 A	8,21 A	8,35 A	8,48 A	8,62 A	8,69 A	8,81 A
Module efficiency	13,34%	13,65%	13,95%	14,25%	14,56%	14,86%	15,16%

*measurement conditions: the electrical specifications are measured under an irradiance level of 1000 W/mq, 1,5 Air mass Spectrum, cell temperature of 25°C.

OPERATING CHARACTERISTICS

		U.M.
Voltage Temperature Coefficient (Voc)	- 128,4	mV/°C
Power temperature Coefficient (Pmp)	- 1,01	W/°C
Current Temperature Coefficient (Isc)	+ 4,93	mA/°C
NOCT (Nominal Operating Cell Temperature)	46	°C

TECHNICAL DRAWING

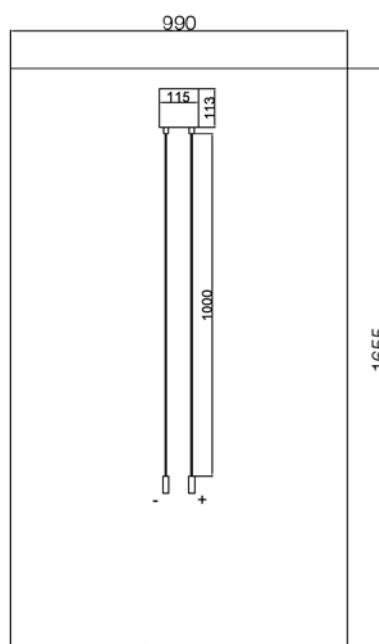
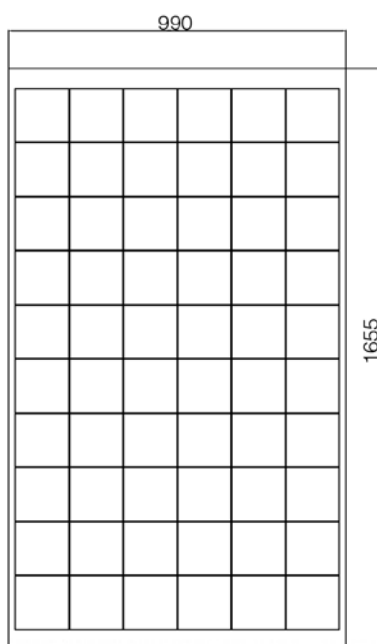

The information shown in the sheet may change without notice as the result of technical updating.



ECLIPSE ITALIA srl

Registered office: 20121 Milano, Corso Venezia, 3 - Italy · Offices and production: 25078 Nozza di Vestone (BS) - Loc. Merlaro - Italy
Tel. +39 0365 870843 · Fax. +39 0365 870851 · P.IVA 06212530965 · www.eclipseitalia.com · info@eclipseitalia.com