

# MT Series (60Cells)

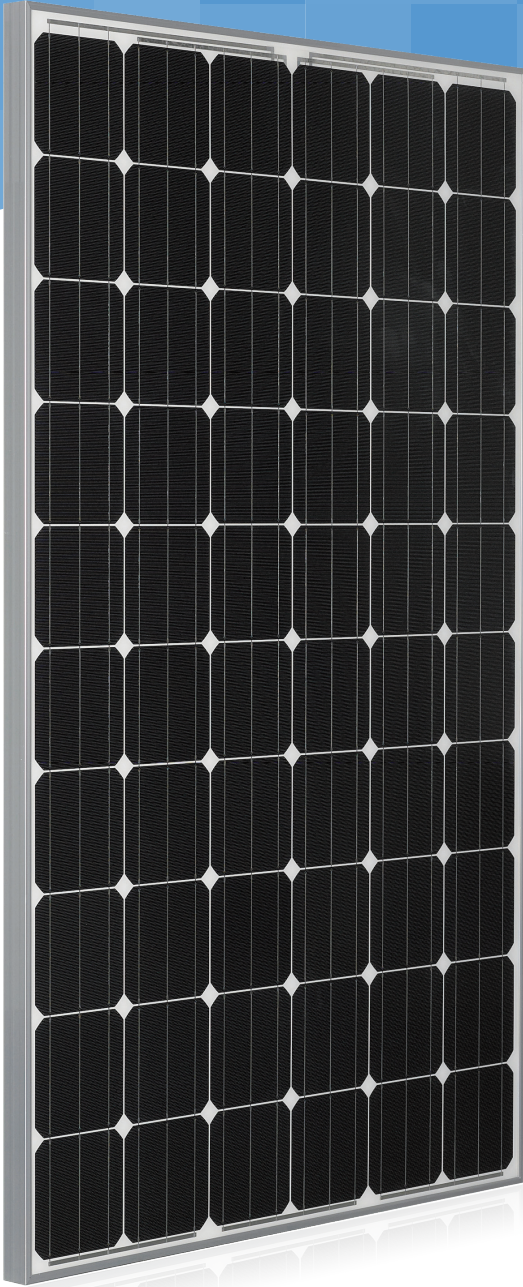

## Mono Crystalline Solar Module (Anti-PID)

E&R Solar provides highly-efficient and highly-trusted products under technological differentiation



### Positive Power Tolerance

Tight positive power sorting of 0W to +5W



### PID Resistance Performance

E&R Solar module have lower Potential Induced Degradation with continuous effort on R&D (\*Pass of TÜV SUD PID TEST)

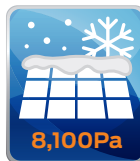

### Superior Durability

E&R Solar's PV modules offer robust design to withstand snow loads up to 8,100Pa and harsh environment



### High quality components

AR coating glass for high sunlight absorption and self-cleaning Anodized Aluminum frame



### Warranty

10 years for product warranty  
10 years for 90.7% of warranted min. power  
25 years for 80.2% of warranted min. power



## Qualifications & Certificates

IEC 61215 : 2005 2nd Edition, IEC 61730-1 : 2004,  
IEC 61730-2 : 2004, UL 1703 listed

E&R Solar

## Mono Crystalline Solar Module

### Physical Characteristics

Cells per Module	60 Cells (6 x 10)
Cell Type	Mono-crystalline Silicon
Module Dimension (L x W x H)	1,645 x 989 x 40 (mm) 64.76" x 38.93" x 1.57" (in.)
Module Weight	18.5Kg (40.78 lbs.)
Front Glass	3.2mm Tempered Glass
Frame	Anodized Aluminum (Black frame available by customer order)
Junction Box	IP65 with 3 bypass diodes
Connector type	MC4 Connector IP67
Cable Length (+/-)	2 x 1,000mm, 4 Sqmm

### Electrical Characteristics

60 Cells Module Description		260MT	265MT	270MT	275MT	280MT
Item	Unit					
Max. Power (Pmax)	Wp	260	265	270	275	280
Power Tolerance	Wp	0 ~ + 4.99				
Open circuit voltage (Voc)	V	38.10	38.50	38.90	38.70	39.00
Short circuit current (Isc)	A	9.04	9.06	9.08	9.10	9.10
Max. Power voltage (Vmp)	V	30.90	31.40	31.40	32.00	32.50
Max. Power current (Imp)	A	8.42	8.44	8.60	8.60	8.62
Module efficiency	%	15.98	16.28	16.59	16.90	17.21

\*STC(Standard Test Condition) : 1,000W/m<sup>2</sup>, AM 1.5, 25°C

### Thermal Characteristics

	Rating	Unit	Value
	NOCT	°C	43±2
Temperature coefficient	Isc	%/°C	+0.06
	Voc	%/°C	-0.35
	Pmax	%/°C	-0.46

\*NOCT(Nominal Operating Cell Temperature) : 800W/m<sup>2</sup>, 20°C, wind speed 1m/s

### Permissible operating conditions

Temperature range	-40°C to +85°C
Maximum system voltage	1,000V DC(IEC), 600V DC(UL)
Maximum surface load capacity	IEC 8,100Pa, JET 5,400Pa
Maximum hailstone impact (diameter/velocity)	25mm / 23m/s

### Packing Specifications

Packing box dimension (L x W x H)	1,720 x 1,065 x 1,100 (mm)
Number of modules per pallet	22
Number of modules per container (40ft)	572

\* Specification subject to technical change without prior notice.  
E&R Solar reserves the rights of final interpretation.

### Module Diagram

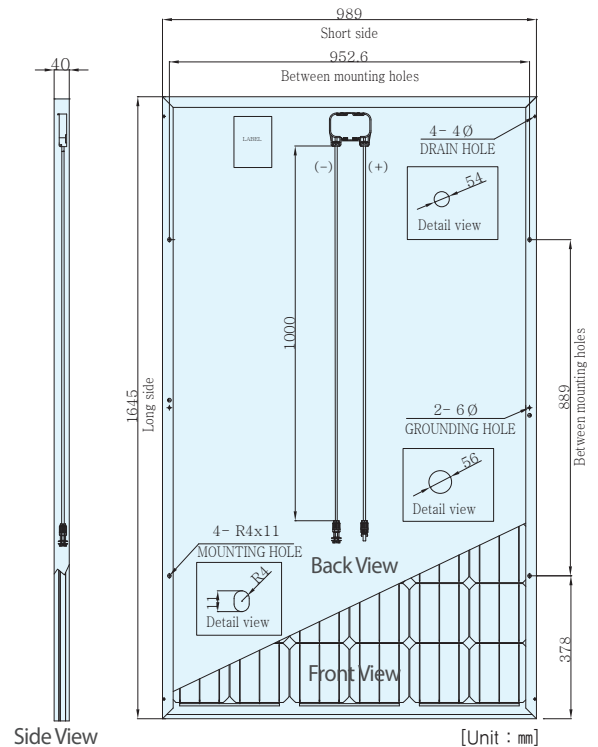

### I-V Curves

