

JHX - xxxM96

Peak Power **245|250|255|260|265** wp



Guaranteed 0-5wp plus output tolerance ensures high return on investment



High module efficiency (up to 15.7%) through superior manufacturing technology

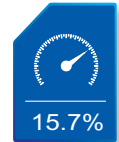

Module can bear snow loads up to 5400Pa and wind loads up to 2400Pa



Certified by the most reputable labs according to IEC:61215;IEC:61730-1/2 standards



Manufactured and certified according to International Quality and Environment Management System (ISO9001,ISO14001,ISO18000)



linear performance warranty

10 years product warranty

25 years power warranty

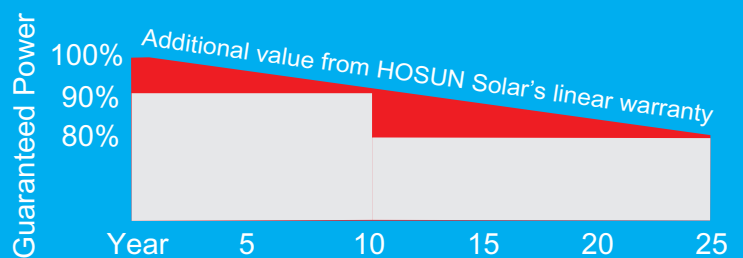

Superior Frame Design
Specially designed drainage holes and rigid construction prevent frames from deforming. Screwless frame design for a long term durability.



The new aluminum alloy (without mounting hole) is quicker in installment and better in protecting module, thus saving the mounting expense. It can help to avoid cracks on solar cells caused during the installment.

ELECTRICAL CHARACTERISTICS

Module Type	JHX-245M96	JHX-250M96	JHX-255M96	JHX-260M96	JHX-265M96
Maximum Power at STC (Pmax)	245W	250W	255W	260W	265W
Maximum Power Voltage (Vmp)	49.30V	49.41V	49.52V	49.72V	49.82V
Maximum Power Current (Imp)	4.97A	5.06A	5.15A	5.23A	5.32A
Open Circuit Voltage (Voc)	59.98V	60.15V	60.31V	61.49V	60.65V
Short Circuit Current (Isc)	5.33A	5.43A	5.46A	5.51A	5.63A
Maximum System Voltage	DC 1000V(TÜV) / DC 600V(UL)				
Operating Temperature	-40°C to +85°C				
Maximum Series Fuse Rating	10A				
Application Class	Class A				

STC: Irradiation 1000W/m², Module Temperature 25°C, AM=1.5 ; Power Measurement Tolerance:±3%

PHYSICAL CHARACTERISTICS

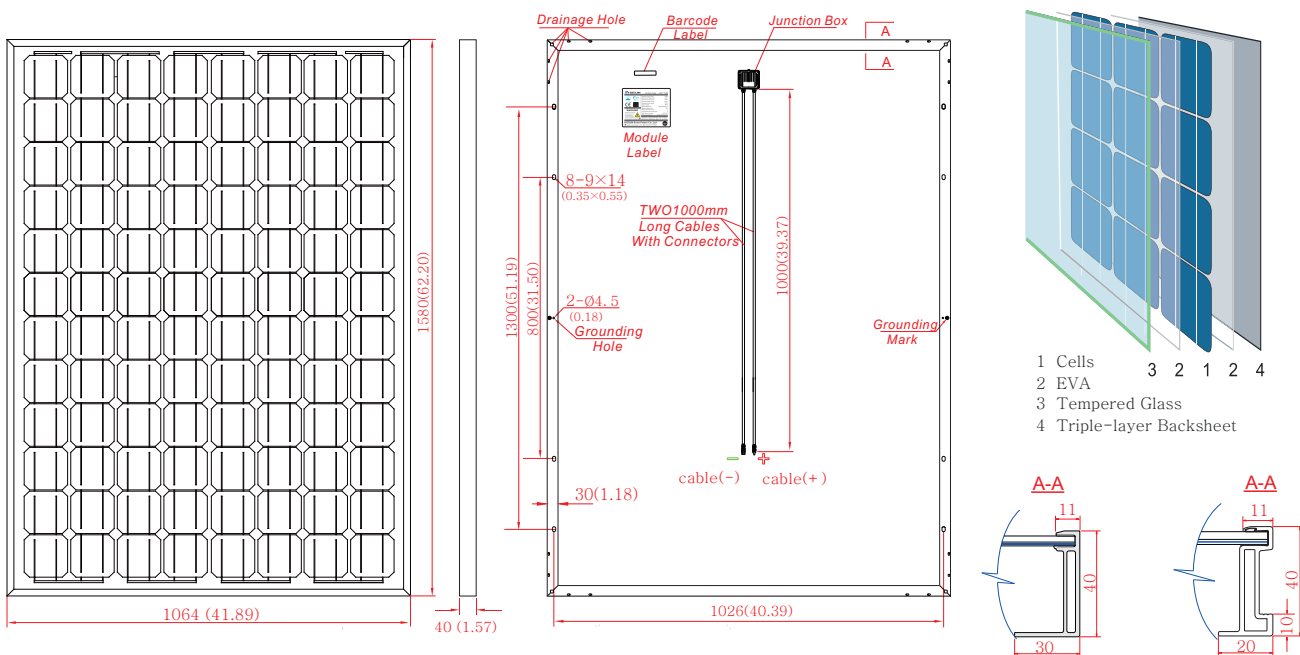

MECHANICAL DATA

Dimension	1580×1064×40mm(62.20×41.89×1.57)
Cell Type	Mono Crystalline Silicon, 125mm × 125mm
Number of Cells	96 cells in series(12×8)
Weight	21.0kg±0.5kg
Front Glass	High Transparency Solar Glass3.2mm
Frame	Anodized Aluminium Alloy
Junction Box	TÜV: IP65 rated / IP67 rated,3 Diodes
Cable	Photovoltaic Technology 4.0mm ² ,1000mm,
Connector	MC-4 / DJ2011-4(SHIHE) Compatible

Current-Voltage & Power-Voltage Curve
JHX-250M96 (cell temperature:25°C)

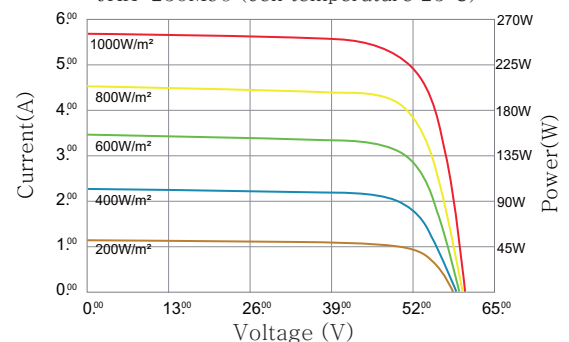

TEMPERATURE RATINGS

Nominal Operating Cell Temperature(NOCT):	47°C(±2°C)
Temperature Coefficient of Pmax	-0.48%/°C
Temperature Coefficient of Voc	-0.34%/°C
Temperature Coefficient of Isc	0.05%/°C

NOCT:Irradiation 800W/m²,ambient temperature 20°C,wind speed 1m/s

PACKING CONFIGURATION

Container	20GP	40GP	40HC
Pieces per pallet	48/52	48/52	50/54
Pallets per container	6	14	14
Pieces per container	288/312	672/728	700/756